

ESWARA HEIGHTS 

UPPAL BHAGAYATH

Your Dream Home Awaits



Promoted by



H.V. CONSTRUCTIONS

PEACE • SECURITY • COMFORT

WE DESIGN YOUR DREAMS



# Elevation



Hv's Eswara heights offers strikingly stylish homes which redefine the living standards. Residing in eminent location Eswara heights is built for modern families who value urban comfort, the freedom of space and the quality of ambience in each apartment making living style above ordinary level of luxury.



## Location Plan & Highlights

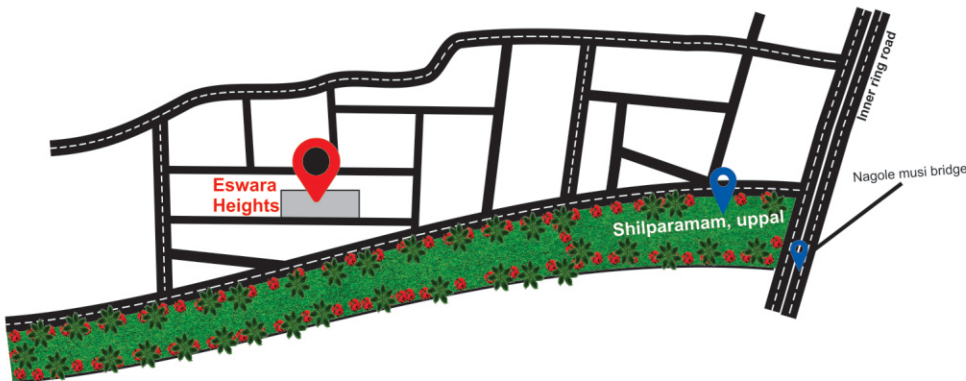

- 👉 300 M to Uppal to Nagol Road.
- 👉 200 M to Shilparamam Uppal.
- 👉 350 M to Nagol Metro Station.
- 👉 3.5 km to DSL Virtue Mall.
- 👉 4 km to NSL Arena IT Hub.
- 👉 3 km to Kamineni Hospital.



# Floor Plan

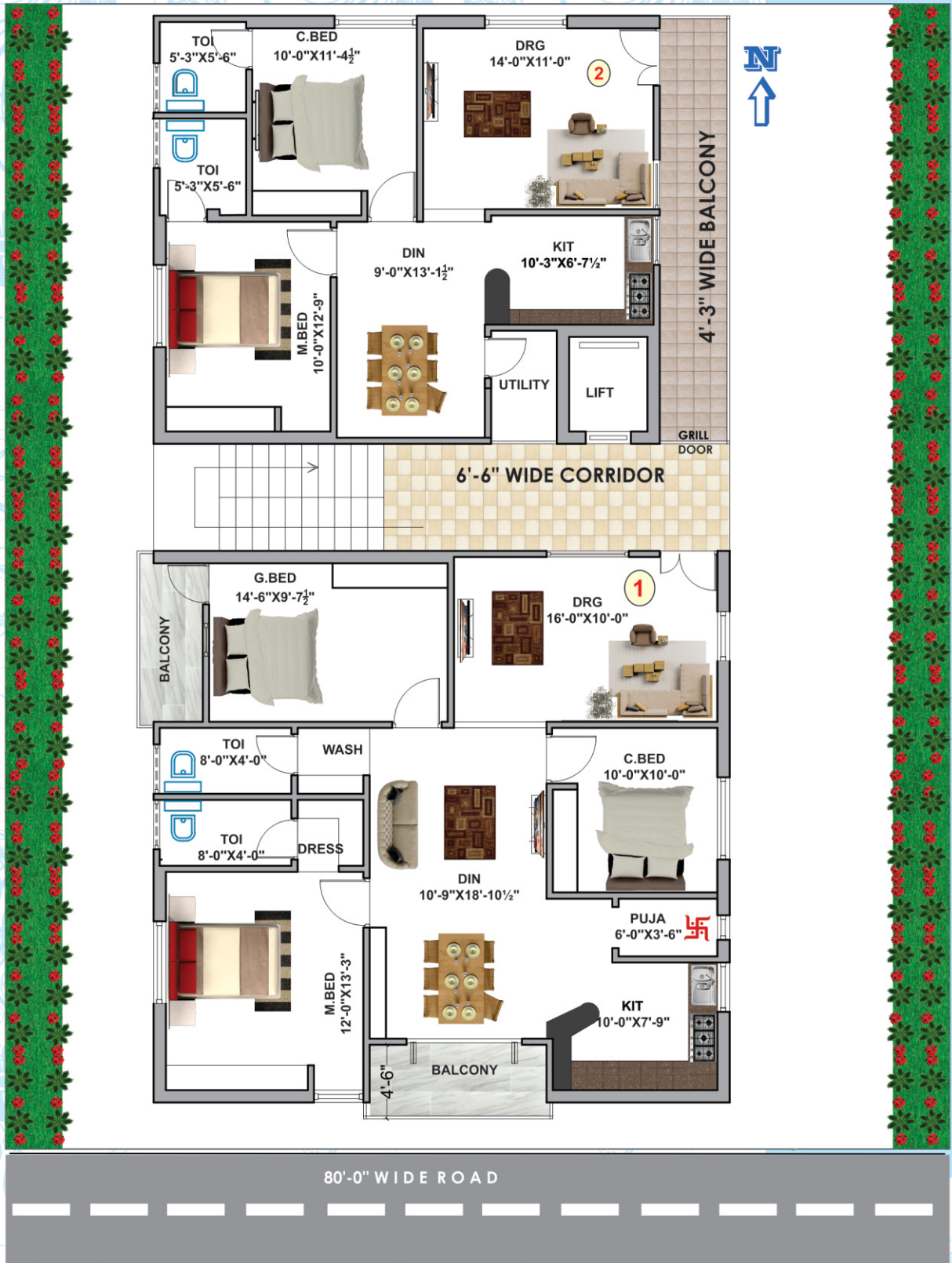

S.No.	FACING	NET AREA	COMMON AREA	SALABLE AREA
1.	North	1172 sft	293 sft	1465 sft
2.	East	880 sft	220 sft	1100 sft

# SPECIFICATIONS

<b>Structure</b>	◆ RCC framed structure with seismic resistant design <b>Bharathi</b> / Cement & Sree High yield TMT steel.
<b>Super Structure</b>	◆ External 9" and Internal of 4 ½" thick walls with <b>light weight red brick</b> in cement mortar. ◆ Compound wall with solid cement brick. ◆ Cement Shelves provided in bedrooms and kitchen. No shelves will be provided in hall.
<b>Plastering</b>	◆ Internal Two coats, with sponge finishing. ◆ External Two coats, with sponge finishing.
<b>Doors and Windows</b>	◆ <b>Main Door</b> : Frame and Shutters with Best Teak Wood with S.S. fittings. ◆ <b>Internal Doors</b> : Medium teak wood frames with Designer flush door shutters with S. S. fittings. ◆ <b>Windows</b> : UPVC Windows with glazed glass and iron safety grills.
<b>Flooring</b>	◆ Vitrified tiles of 800"x800" size of branded company for Hall, Dining, Bed Rooms and kitchen. ◆ External flooring within the compound wall is of PCC flooring, and Parking Tiles in Parking area. ◆ Steps with <b>Granite with Stainless Steel Railing of regular design.</b>
<b>Kitchen</b>	◆ Granite platform with Stainless Steel or Granite sink with Granite dado up to 2' height. ◆ Provision for exhaust fan/Chimney.
<b>Toilets</b>	◆ All toilets with Anti skid ceramic tile flooring and 6' 6" wall cladding with digital tiles of branded company. ◆ WC or EWC in attached toilet and Indian WC in common toilet of branded company. ◆ Hot and cold wall mixture with shower in all toilets. ◆ Branded tap fittings. ◆ Geyser provision will be given for all toilets. ◆ CPVC pipeline <b>Ashirvad /Supreem</b> with standard tap fittings, and Drainage pipe line with rigid P V C fittings.
<b>Electrical</b>	◆ Adequate electrical points with Concealed copper wiring ( <b>Anchor or Great White or</b> equivalent made). ◆ Two way switches and TV provision will be given in Master Bedroom. ◆ Computer power point and internet wiring will be given in children bedroom. ◆ Telephone and Internet wiring facility will be given in hall. ◆ AC Provision will be given in master bedroom. ◆ Inverter provision will be provided. ◆ Washing machine provision will be provided. ◆ <b>Anchor Roma / Great White or Polycab</b> or equivalent made Modular electrical switches will be provided.
<b>Painting</b>	◆ <b>Internal</b> : Asian Premium Emulsion paint with roller finishing over Birla/ Asian Putty. ◆ <b>External</b> : Elevation Putty finishing with apex paints and all other sides with ACE Paints.
<b>Others</b>	◆ <b>M.S Gate will be provided as per the design.</b> ◆ <b>Bore water will be supplied from common over head tank.</b> ◆ <b>Common borewell and motor of branded company will be provided.</b>
<b>Note</b>	◆ The Owner/buyer is free to make necessary internal alterations in the specifications or plan to suit his requirements. Extra cost for all such alterations should be borne by the Purchaser/Owner. ◆ The owner/buyer is not allowed to make any changes in elevation side including colours. ◆ Registration charges, GST, house assessment charges, water connection charges, electricity meter and other statutory taxes/charges of State & Central Govt should be borne by the Owner/purchaser.
<b>Amenities:</b>	◆ <b>Watchman room</b> ◆ <b>Generator backup to common lighting and lift</b> ◆ <b>Three phase electrical transformer</b> ◆ <b>Lift</b> ◆ <b>Parking for car with 8"x12" size.</b>

Promoted by



**H.V. CONSTRUCTIONS**

PEACE • SECURITY • COMFORT

Mahalaxmi Arcade, Plot # 1, P & T Colony, Warangal Highway, Medipally (V), Ghatkesar (M), Medchal Dist. - 500 092.

E-mail : hvconstructions.2014@gmail.com  
website : www.hvconstructions.com

Cont. : **76800 25633, 98491 99077** Office : **040 - 35928133**

Consultant Engineers

**S A A C**

Kothapet, HYDERABAD - 60.

Note : This brochure is only conceptual not a legal offer

Brochure Designed by

**B&W Printers @ 9959 222 555**